

KEY PLAN



INSET 1
Warrington Road to Halton Farnworth Rugby Club



Legend :

- Cycle Track
- Footway / Hard Verge
- Shared Surface [cyclist and pedestrian mixed]
- Grass Verge / Green Space
- Proposed Road/ Cycle track Markings
- Blister Paving Buff
- Blister Paving Red
- Tram and Ladder Paving
- Trees Removed
- New street tree planting

Notes :

1. Signal junction operation unchanged
2. Bus stop retained and accommodated
3. Right-turn lane retained
4. New cycle compliant parapet on bridge
5. Removal of central hatching and right turn lane



Image taken from LTN 1/20

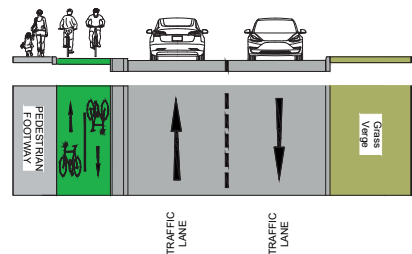

Cross-section with protected cycle route

Crown copyright and database rights 2024. OS licence 100018552



KEY PLAN



INSET 2
Halton Farnworth Rugby Club to Lunt's Heath Rd



Legend :

- Cycle Track
- Foot way / Hard Verge
- Shared Surface [cyclist and pedestrian mixed]
- Grass Verge / Green Space
- Proposed Road/ Cycle track Markings
- Blister Paving Buff
- Blister Paving Red
- Tram and Ladder Paving
- Trees Removed
- New street tree planting

Notes :

1. Kerbside parking restrictions introduced
2. New push button crossing
3. Access to properties maintained
4. Bus stop retained and accommodated
5. Carriageway widened locally

New Crossing Point



Crown copyright and database rights 2024. OS licence 100118552

KEY PLAN



- Notes :
1. Junction layout amended, left turn slip retained
 2. Potential for route to continue under separate scheme
 3. Potential for route to continue under separate scheme
 4. Existing disused bus lane to be converted to cycleway if scheme is progressed before adjacent Cronton Lane Scheme. Cyclists to rejoin carriageway at end of bus lane
 5. Junction layout amended under separate Cronton Lane Active Travel Scheme

Legend :

- Cycle Track
- Foot way / Hard Verge
- Shared Surface [cyclist and pedestrian mixed]
- Grass Verge / Green Space
- Proposed Road/ Cycle track Markings
- Blister Paving Buff
- Blister Paving Red
- Tram and Ladder Paving
- Trees Removed
- New street tree planting

INSET 3
Lunt's Heath Road



Example of similar crossing in St Helens

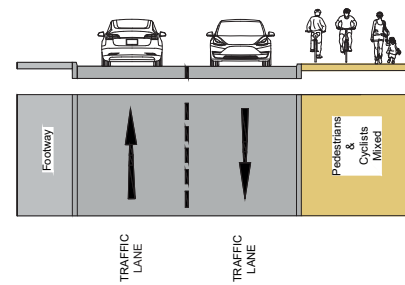

Cross-section with shared space

Crown copyright and database rights 2024. OS licence 100118552

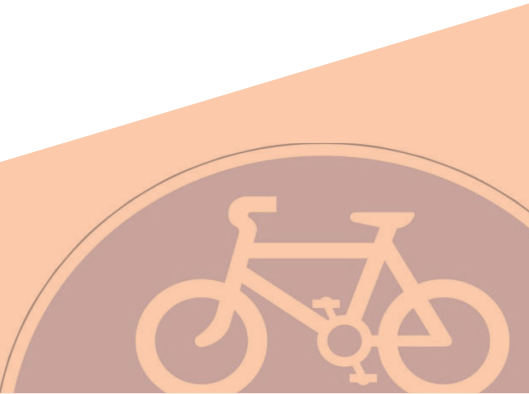

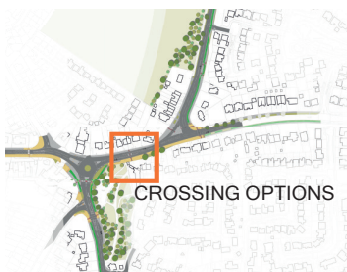
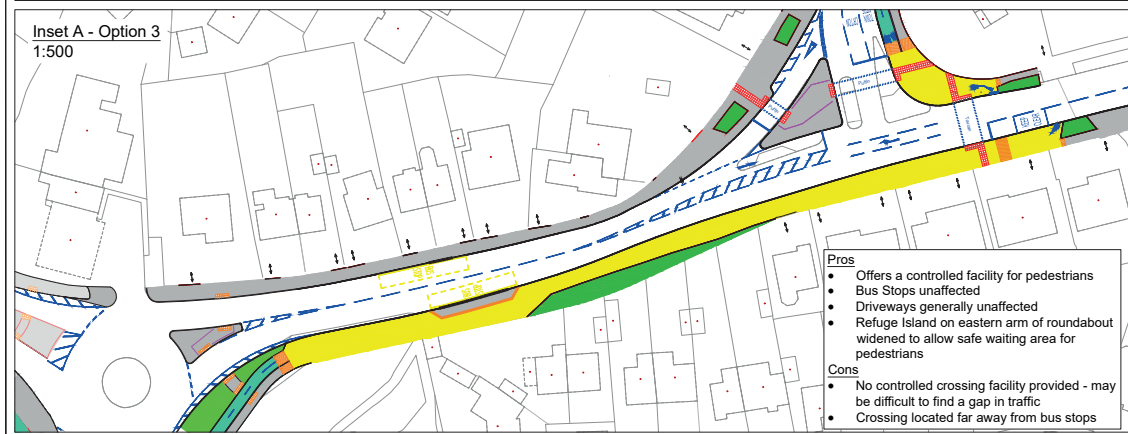
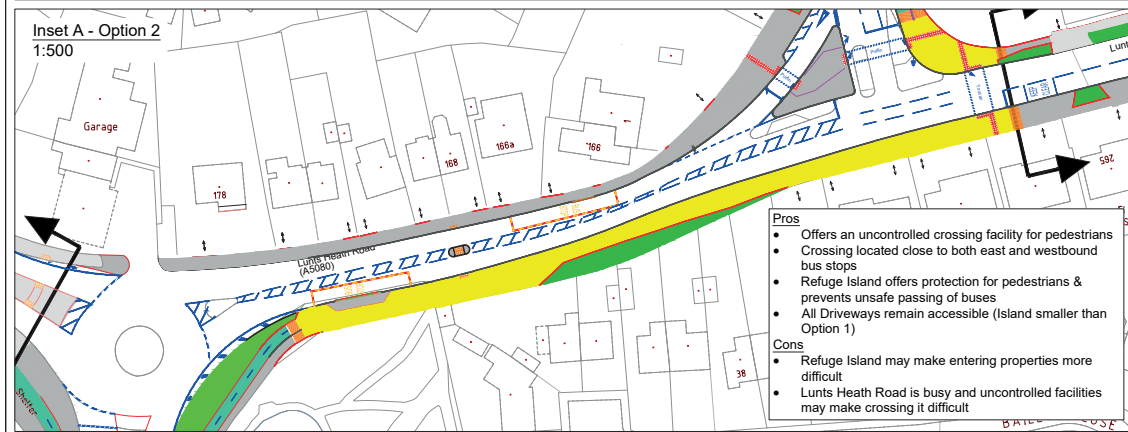
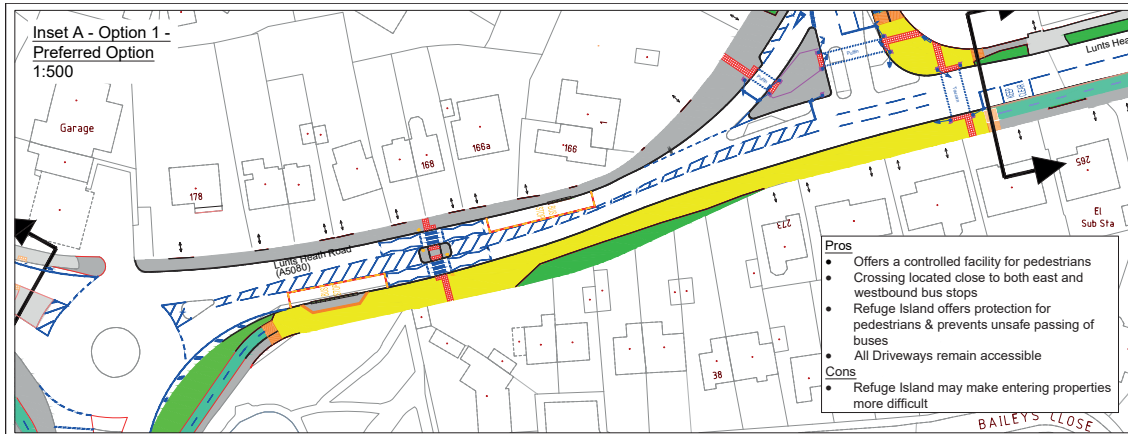

Crown copyright and database rights 2024. OS licence 100018552

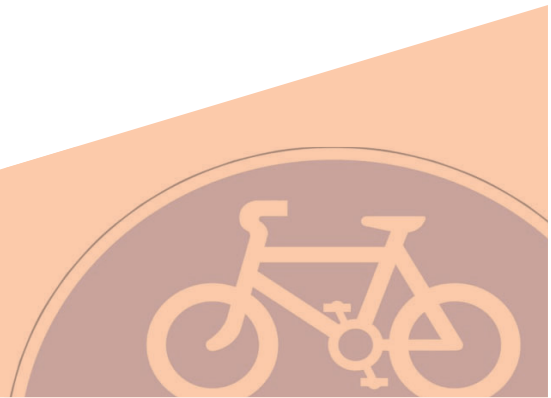

KEY PLAN



INSET 4
Upton Lane to Pit Lane



Legend :

- Cycle Track
- Foot way / Hard Verge
- Shared Surface [cyclist and pedestrian mixed]
- Grass Verge / Green Space
- Proposed Road/ Cycle track Markings
- Blister Paving Buff
- Blister Paving Red
- Tram and Ladder Paving
- Trees Removed
- New street tree planting

Notes :

1. Toucan crossing retained
2. Side road junction table introduced, see example image below
3. Junction signalled to aid crossing movements



2 Image taken from LTN 1/20

Crown copyright and database rights 2024. OS licence 100118552

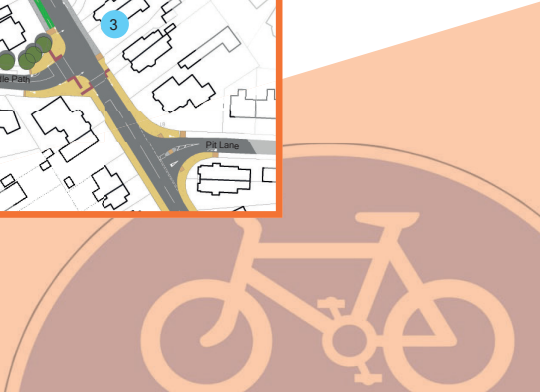

KEY PLAN



INSET 5
Pit Lane to Lancaster Road



Legend :

- Cycle Track
- Foot way / Hard Verge
- Shared Surface [cyclist and pedestrian mixed]
- Grass Verge / Green Space
- Proposed Road/ Cycle track Markings
- Blister Paving Buff
- Blister Paving Red
- Tram and Ladder Paving
- Trees Removed
- New street tree planting

Notes :

1. Existing Puffin Crossing upgraded to a Toucan Crossing
2. 4m wide route for pedestrians and cyclists [wider than existing]
3. Junction signalised to aid crossing movements
4. Road markings to indicate priority for cyclists and pedestrians
5. Existing off road route
6. Route continues onto existing shared surface which will be resurfaced if necessary
7. New controlled crossing facilities provided, see example image below



8 New controlled crossing facilities provided, taken from LTN 1/20



View 01 - Existing



View 02 - Proposed

Crown copyright and database rights 2024. OS licence 100118552

